

Name \_\_\_\_\_ Date \_\_\_\_\_

**Listen to the directions. Fill in the missing words.**

1. A: Excuse me, can you tell me \_\_\_\_\_ the Radiology Center \_\_\_\_\_?

B: Sure. Go \_\_\_\_\_ down this hallway. \_\_\_\_\_ at the elevators, and then turn right at the \_\_\_\_\_. It's just down that \_\_\_\_\_.

2. A: Excuse me, can you \_\_\_\_\_ me find the Dental \_\_\_\_\_?

B: The Dental Clinic? Sure, it's \_\_\_\_\_ ahead. You can \_\_\_\_\_ it from \_\_\_\_\_.

I see it, thanks.

3. A: Excuse me, Where's the \_\_\_\_\_?

B: The elevator? Walk \_\_\_\_\_ the waiting area, and \_\_\_\_\_ the Physical Therapy Center. Turn \_\_\_\_\_ and you'll \_\_\_\_\_ it.

A: Thanks.

ASK FOR  
DIRECTIONS TO:

1. The Cafeteria
2. The Cancer Center
3. Pediatrics
4. Physical Therapy

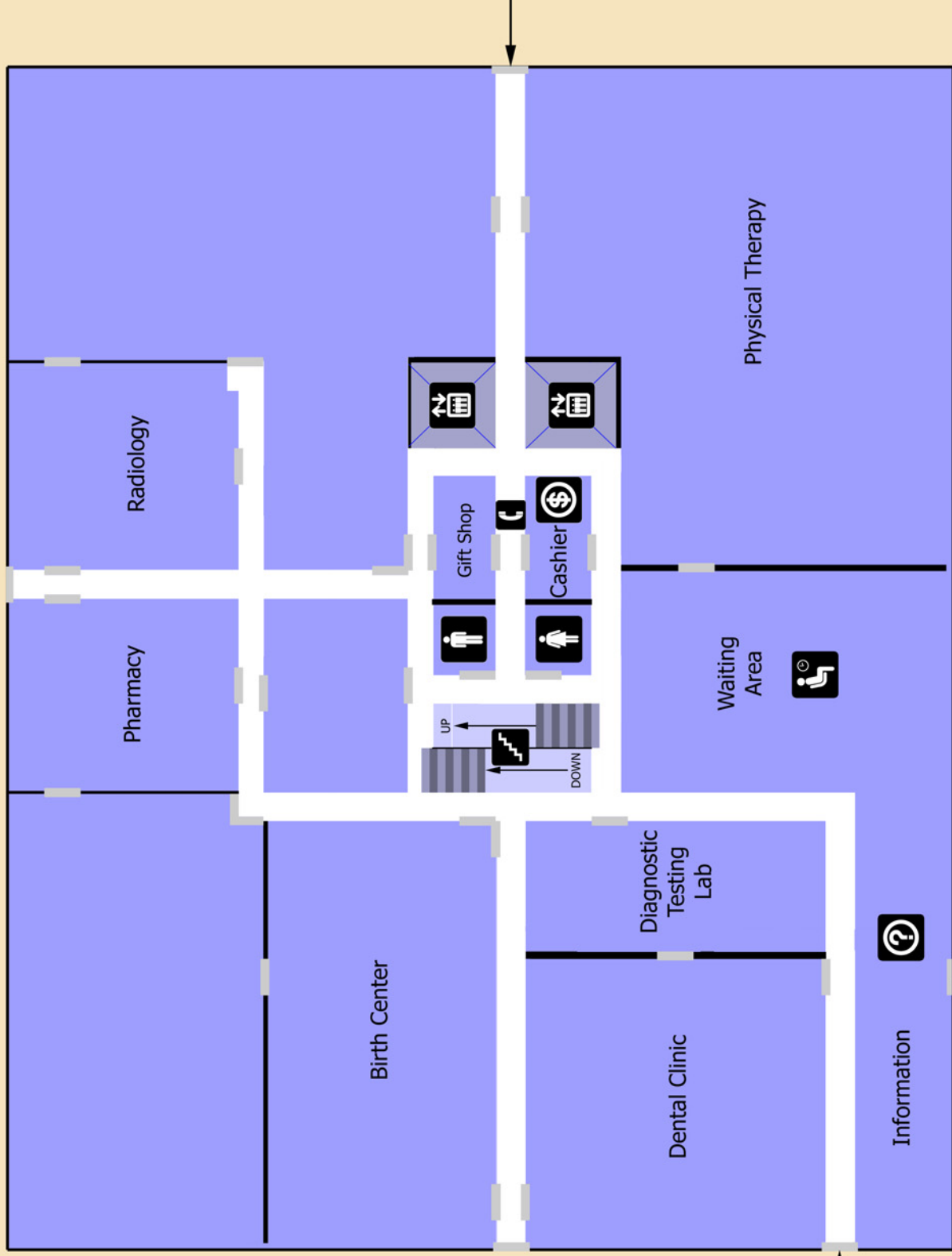

You  
are  
here

ASK FOR  
DIRECTIONS TO:

1. The Birth Center
2. The Pharmacy
3. The Cashier
4. The Dental Clinic

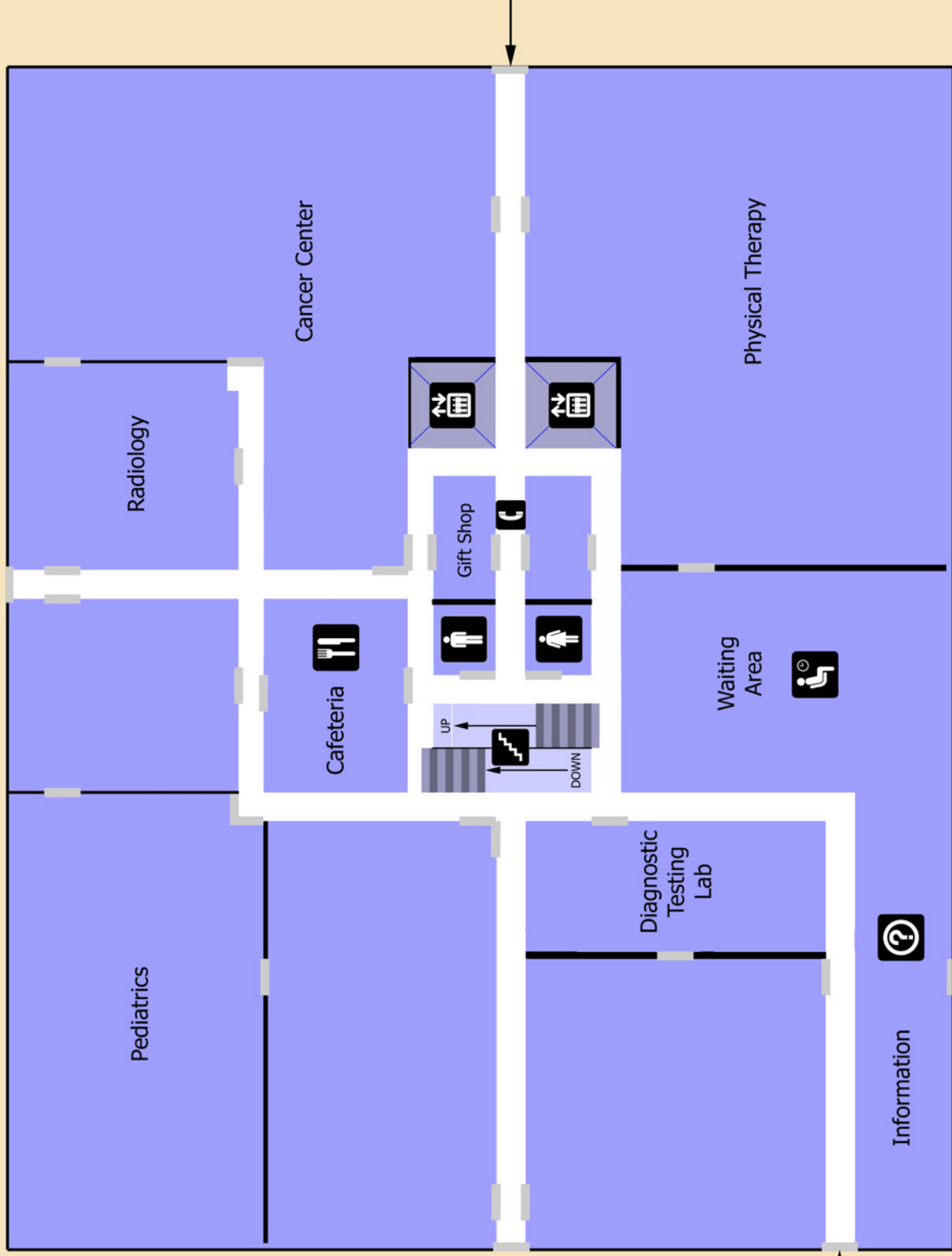

Name \_\_\_\_\_ Date \_\_\_\_\_

## Information for new dental patients

1. For your dental appointment, please \_\_\_\_\_ some identification, such as a driver's license.

- a. answer
- b. bring
- c. consider
- d. tooth

2. If you have insurance, please show your \_\_\_\_\_ to the receptionist.

- a. appointment
- b. card
- c. dentist
- d. telephone

3. If you need to \_\_\_\_\_ an appointment, call 24 hours before your appointment day.

- a. cancel
- b. come
- c. reply
- d. respond

4. Call the receptionist if you have any \_\_\_\_\_

- a. consider
- b. questions
- c. quiet
- d. registration