



**Work English:
Abdul's Story**

Introduction

This man can speak a little English. He can not read or write in English. He has a problem at work.

Abdul's Story

Hi. My name is Abdul. I am from Morocco. In my country I was an accountant.

When I came to the U.S., I needed a job. My friend told me about a job in a restaurant.

I went to the restaurant. The boss said, "Do you speak English?" I was scared, I said, "Yes." I didn't tell him that I can't read.

I got a job as a dishwasher. The boss gave me a schedule. The schedule had: Abdul – morning shift, 6:00. I came to work at 6 o'clock in the evening.

The boss was mad! He said, "What happened?" I was confused, but I stayed calm. I said, "I'm sorry. I don't understand. It's 6 o'clock." I said, "Please help me. I am a hard worker."

The boss explained the schedule. He told me to ask questions when I don't understand.

I will work hard and I will ask questions. I will learn to read and write in English.

Conclusion

It is important to ask questions at work. Ask someone to explain when you do not understand.

Lesson A *Listening*



A Look at the pictures. Write the words.

cashier cook doctor electrician nurse truck driver

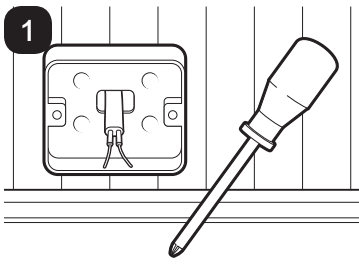

e l e c t r i c i a n

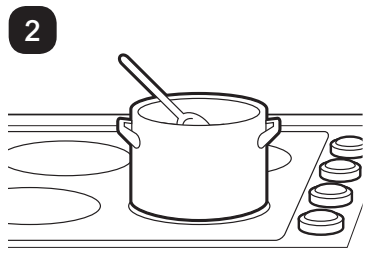

c _ _ _ k

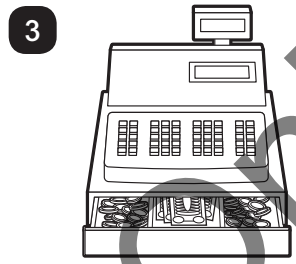

c _ _ _ _ r

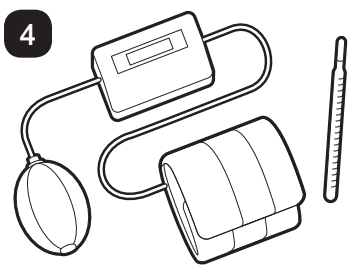

n _ _ _ _ e

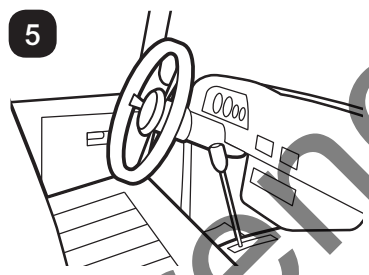

t _ _ _ k
d _ _ _ _ r

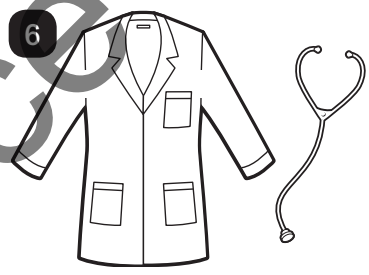

d _ _ _ _ _ r

B Complete the word maps. Use the words from Exercise A.

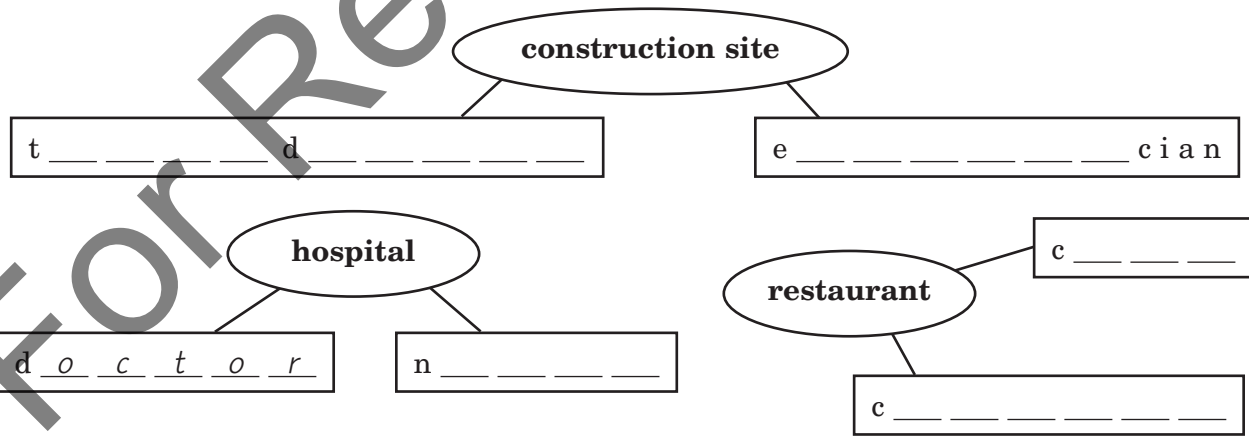

C Write three more jobs.

1. _____ 2. _____ 3. _____



Lesson A *Listening*

A Look at the pictures. Write the words.

cashier cook doctor electrician nurse truck driver

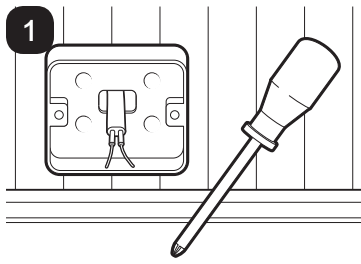

electrician

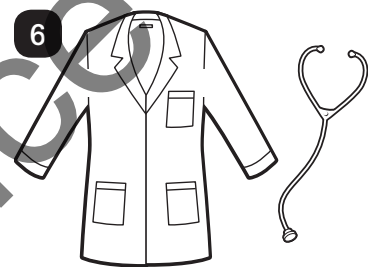
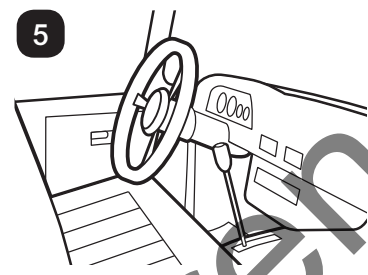
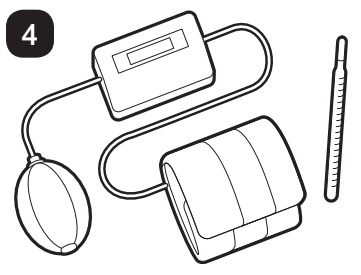
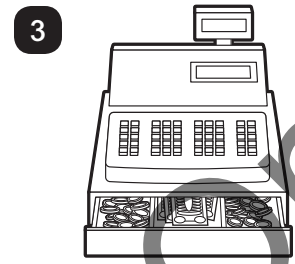
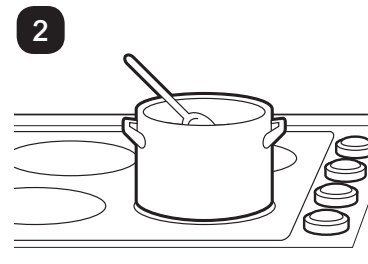

B Complete the word maps. Use the words from Exercise A.

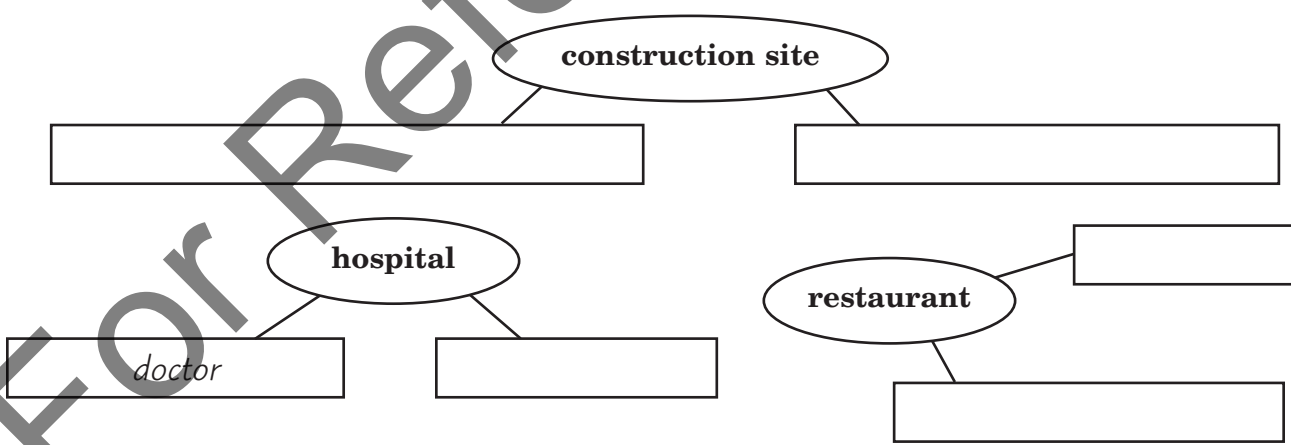

C Write four more jobs.

1. _____
2. _____
3. _____
4. _____

Lesson A *Listening*



A Look at the pictures. Write the jobs.

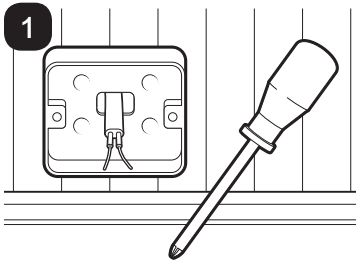

_____ *electrician* _____

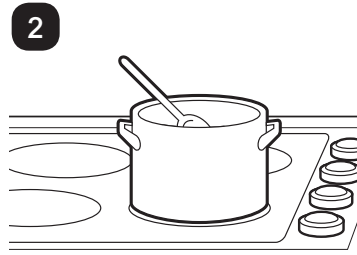

_____ _____

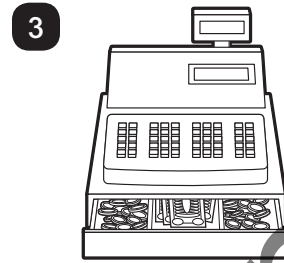

_____ _____

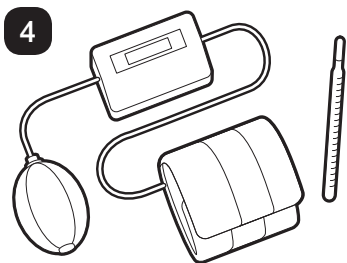

_____ _____

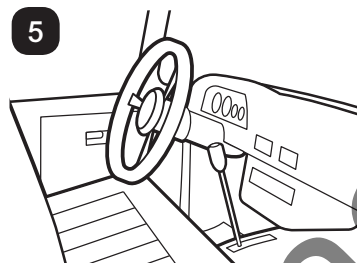

_____ _____



_____ _____

B Complete the word maps. Use the words from Exercise A.

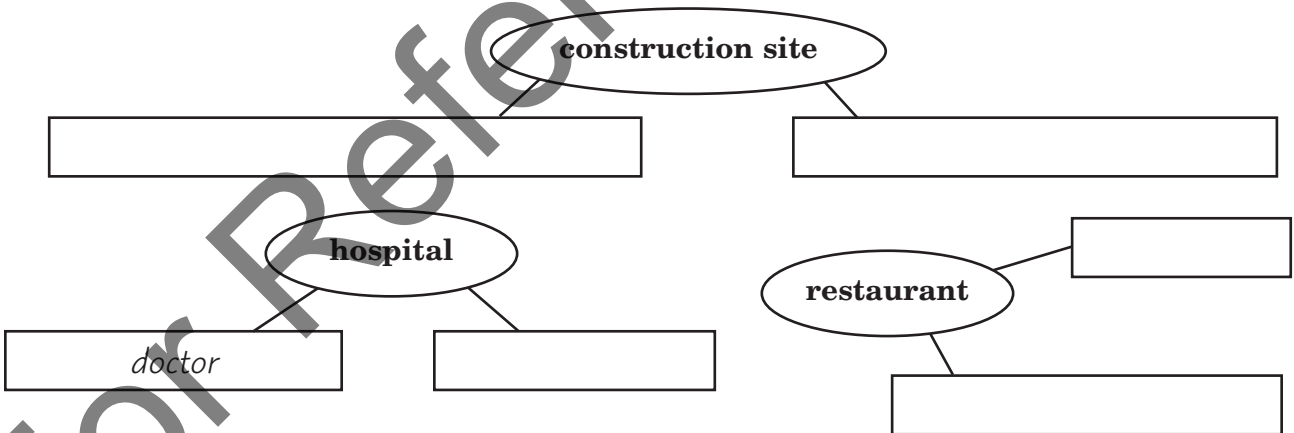

C Write six more jobs.

1. _____
2. _____
3. _____
4. _____
5. _____
6. _____



Lesson B I was a teacher.

A Read the questions. Look at the chart. Circle the answers.

	Job in 2008	Job now
Maria	cashier	cook
Tom	nurse	student
Angelo and Juan	servers	managers

- | | | |
|-------------------------------------|----------------------|-------------------|
| 1. Was Maria a cashier? | <u>Yes, she was.</u> | No, she wasn't. |
| 2. Was Tom a nurse? | Yes, he was. | No, he wasn't. |
| 3. Is Maria a cook now? | Yes, she is. | No, she isn't. |
| 4. Is Tom a nurse now? | Yes, he is. | No, he isn't. |
| 5. Were Angelo and Juan managers? | Yes, they were. | No, they weren't. |
| 6. Are Angelo and Juan servers now? | Yes, they are. | No, they aren't. |

B Circle the correct sentences. Use the information from Exercise A.

- | | |
|--|--|
| 1. <u>Maria was a cashier.</u> | Maria wasn't a cashier. |
| 2. Tom was a student in 2008. | Tom wasn't a student in 2008. |
| 3. Tom was a nurse. | Tom wasn't a nurse. |
| 4. Angelo and Juan were servers in 2008. | Angelo and Juan weren't servers in 2008. |
| 5. Angelo and Juan are managers now. | Angelo and Juan aren't managers now. |

C Complete the chart. Use your own information.

What was your job before?	What is your job now?

D Complete the conversation.

Your friend What do you do?

You I'm a _____.

Your friend What was your job before?

You I was a _____.

Lesson B

I was a teacher.



A Read the questions. Look at the chart. Circle the answers.

	Job in 2008	Job now
Maria	cashier	cook
Tom	nurse	student
Angelo and Juan	servers	managers

1. Was Maria a cashier? Yes, she was.
2. Was Tom a nurse? _____
3. Is Maria a cook now? _____
4. Is Tom a nurse now? _____
5. Were Angelo and Juan managers? _____
6. Are Angelo and Juan servers now? _____

B Complete the sentences. Use the information from Exercise A.

1. Maria was a cashier.
(was / wasn't)
2. Tom _____ a student in 2008.
(was / wasn't)
3. Tom _____ a nurse.
(was / wasn't)
4. Angelo and Juan _____ servers in 2008.
(were / weren't)
5. Angelo and Juan _____ managers now.
(are / aren't)

C Complete the chart. Use your own information.

What was your job before?	What is your job now?

D Complete the conversation.

Your friend What do you do?

You _____

Your friend What was your job before?

You _____



Lesson B I was a teacher.

A Look at the chart. Read the answers. Write the questions.

	Job in 2008	Job now
Maria	cashier	cook
Tom	nurse	student
Angelo and Juan	servers	managers

- Was Maria a cashier _____? Yes, she was.
- _____? Yes, he was.
- _____? Yes, she is.
- _____ nurse now? No, he isn't.
- _____ managers? No, they weren't.
- _____ servers now? No, they aren't.

B Complete the sentences. Use the information from Exercise A.

- Maria was a cashier.
- Tom _____ a student in 2008.
- Tom _____ a nurse.
- Angelo and Juan _____ servers in 2008.
- Angelo and Juan _____ managers now.

C Complete the chart. Use your own information.

	Job before?	Job now?
You		
Your friend		

D Complete the conversation.

Friend What do you do?

You _____

Friend What does your friend do?

You _____

Friend What was your job before?

You _____

Friend What was his / her job before?

You _____